

SCALE: 1" = 10'-0"

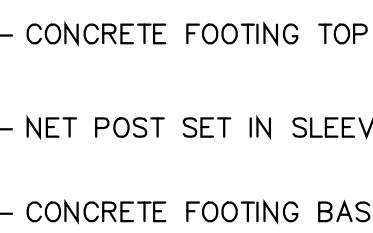

NOT TO SCALE



NOT TO SCALE

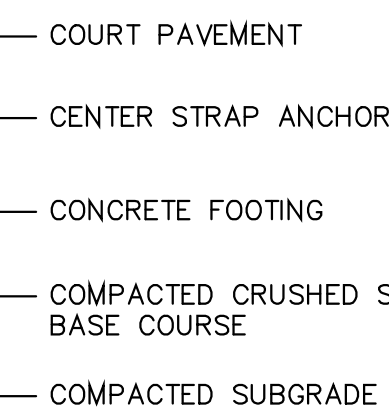

NOT TO SCALE

FOR NEW OR EXISTING ASPHALT SURFACES

The installation guideline is intended as a general reference to describe product usage and construction techniques which will tend to provide an evenly textured, cushioned, color surface for new or existing hot mix asphalt pavement tennis courts.

Surface must meet or exceed the American Sports Builders Association (ASBA) applicable Guidelines. Upgrading and recoating previously colored surfaces requires the surface and base construction to be in sound condition and in compliance with the applicable ASBA guidelines.

Before the application of Deco products, the court surface shall be flooded with water and allowed to drain. Any depressions capable of submerging a U.S. five-cent piece after one hour should be marked with chalk, not crayon or a grease pencil. These areas must be allowed to thoroughly dry. Once dried, apply acrylic patch binder 920-39 to the marked area(s). See Specification 920-39 for details.

Deco recommends 1-2 coats of Acrylic Resurfacer 920-29 prior to the application of any Deco Surfacing System. The undiluted coverage rate for Acrylic Resurfacer is approximately 0.06 gallons per square yard, per application.

Acrylic Resurfacer must be allowed to cure a minimum of 2 hours before applying additional acrylic coatings, assuming 70°F temperatures and 50% relative humidity. Low temperature and high humidity will increase drying time dramatically.

Before re-coating, each application of DecoBase II must be allowed to fully cure. Under optimum installation conditions (70°F temperatures and 50% relative humidity), a maximum of two coats per day can be installed.

The Deco color surfacing system consists of two distinct components: DecoBase I acrylic texture coating and DecoColor MP Classic. DecoBase is supplied as an unpigmented concentrate intended to be tinted with DecoColor MP Classic. Two (2) applications have proven to give excellent performance results. The undiluted coverage rate is approximately 0.06 gallons per square yard, per application (150 square feet per gallon). If applied over DecoBase II the undiluted coverage rate is approximately .0865 gallons per square yard, per application (105 square feet per gallon).

One (1) finish course of DecoColor MP Classic has proven to give excellent performance results. The undiluted coverage rate for the DecoColor finish course is approximately 0.04 gallons per square yard, per application.

One (1) application has proven to give excellent coverage. Approximately $\frac{3}{4}$ gallon is needed for a standard tennis court.