

TOWN MANAGER'S REPORT

TO: Honorable Town Council Members

FROM: Karl F. Kilduff, Town Manager

DATE: February 1, 2023

Please find my report concerning various items of interest to the Town Council and community.

1. Council Business:

- FY2023-24 Budget – The budget remains front and center. Meetings have taken place with all departments or boards requesting funding in the budget. I am making budget adjustments and am coordinating with the Superintendent of Schools on capital budget items. We are still tracking budget assumptions for outside vendors like insurance, pension, etc... which can have a major impact on expenditures.

As noted previously, on the revenue side of the budget, the Governor will deliver his budget in early February which is an important starting point for us to understand how local grants-in-aid are assumed in his budget.

- EDC Goal Setting – The EDC is essentially done with their goal setting process. Their work will be voted on at the next regularly scheduled EDC meeting for adoption. This should give them a focus and stay focused on activities which impact economic development locally. As noted previously, I would anticipate that they will want to come to a future Town Council meeting to discuss their plans.

2. River COG:

The Council of Governments met again on January 25, 2023. Some of the meeting highlights included:

- Presentation of I-95 study - The DOT is looking at I-95 from Branford to the Rhode Island border to evaluate ways to increase capacity on the highway to address congestion. Design concepts could address high volumes of traffic, short off ramps and tight curves which slows speeds. This DOT study will carry on through 2023. A virtual public meeting was held in the fall of 2022. Concepts and design alternatives are being screened for possible identification in the spring of 2023. Additional outreach is supposed to follow after that which should include impacted communities. The DOT is planning another virtual public meeting this summer. The final study is supposed to be completed by the fall.
- CEDS Public Comment – the COG's Comprehensive Economic Development Strategy (CEDS) is out for public comment at this time. It is expected that the COG will vote on the plan in March. A CEDS is tool to help leverage additional federal funding and our region is the only one in the State without a CEDS.

3. Miscellaneous:

- Union Contract Negotiation – Union contract negotiations are starting up this month with preliminary meetings and information exchange requests. Negotiations need to be completed for entire successor agreements to the Police and Dispatchers Unions. Public Works, Clerical and Supervisors all have wage re-openers where only wages are subject to negotiations. Additionally, the Police Union wants to continue pension negotiations which were put on hold in 2018.
- Landfill Capping Project – Our permit to cap the landfill is in the review queue with DEEP. Plainville and West Hartford are ahead of us in the process taking the same approach proposed here. Plainville was recently approved by DEEP after 1 year in their permitting process. West Hartford is in front of us and is looking to get out of DEEP permitting sooner than 1 year. Feedback on their review process can help us move forward faster too. The designs are basically the same. DEEP was looking for West Hartford to complete another permit form to speed things along. We are looking at that same form for our project. I will likely need the Council to provide some additional engineer fee funding to complete this additional form. While not required (and Plainville was approved without it), it was represented that it could help compress the review time from the 1 year experienced by Plainville.
- Eversource Tree Trimming Notice – Attached to this report is an additional notice of planned tree trimming in Clinton for areas for “low reliability”.
- Coastal Resiliency – As I have reported previously, the Council may want to think about creating a Coastal Resiliency committee to assist in the regional grant project. Such a Committee could include representation from the Council and different boards and commission which could be impacted by such efforts to help participate in the process and guide the recommendations as it relates to the needs of Clinton. I will prepare a draft for future consideration.



To our community partners:

At Eversource, we are dedicated to delivering reliable energy and providing excellent customer service. Our comprehensive vegetation management program includes year-round tree work to protect the electric system. Trees are the number one cause of outages during storms in Connecticut.

Statewide, our data shows a continued need for regular tree maintenance in the face of drought, tree disease and stronger storms. Each year, we complete tree work along 4,000 miles of overhead electric distribution lines around the state. The enclosed Tree Reliability Scorecard provides a visual representation of vegetation management **in your community**.

It includes:

- An overview of our 2023 tree work plan
- The number of blocked roads caused by trees during storms
- The number of customers who refused our proposed tree work
- The impact of tree reliability on customers

Additionally, we have identified 45 segments of the electric system where power outages had major impacts to customers, and in many cases to critical facilities, in the past. **A poor performing device segment has been identified in your town.** As a result, we plan to conduct an assessment in the poor performing device area to complete additional tree work. This work may involve removing *hazardous* trees outside our normal clearance zone. We will not complete any work without proper permissions.

While we always provide a map of scheduled tree work to our communities ahead of time, we believe these enhanced communications make it easier than ever to understand how thoughtful tree work strengthens the grid. Our expert Arborists plan to work closely with community leaders and residents to discuss plans and seek permission before tree work begins sometime around July. Dale McLeod, an Eversource Arborist, will be the point of contact for all aspects of the work in your community. Dale McLeod can be reached at 860-310-9371.

If you have any questions regarding Eversource's vegetation management program, please contact me at 860-665-6103.

Sincerely,

Sean Redding,

Eversource Manager of Vegetation Management

Enc: Town Scorecard, Poor Performing Device Segment Map

EVERSOURCE

CLINTON



DISTRIBUTION TREE RELIABILITY

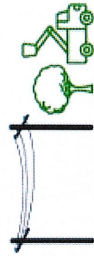

TOTAL MILES SCHEDULED

0.0

TOWN TOTAL

80.2

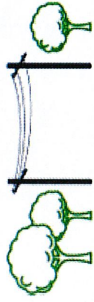

BACKBONE MILES SCHEDULED

0.0

TOWN TOTAL

21.5

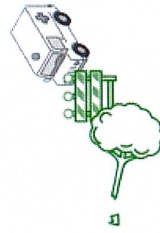

BLOCKED ROADS (2018-2022)

85



CUSTOMER REFUSALS & LIGHT TRIMS
(2018-2022)

135

TREE RELIABILITY 2022

CUSTOMERS SERVED

7,221

PERCENT TREE-RELATED OUTAGES

41%

OUTAGES

158

CUSTOMERS IMPACTED

4,862

MINUTES CUSTOMERS IMPACTED

277,381

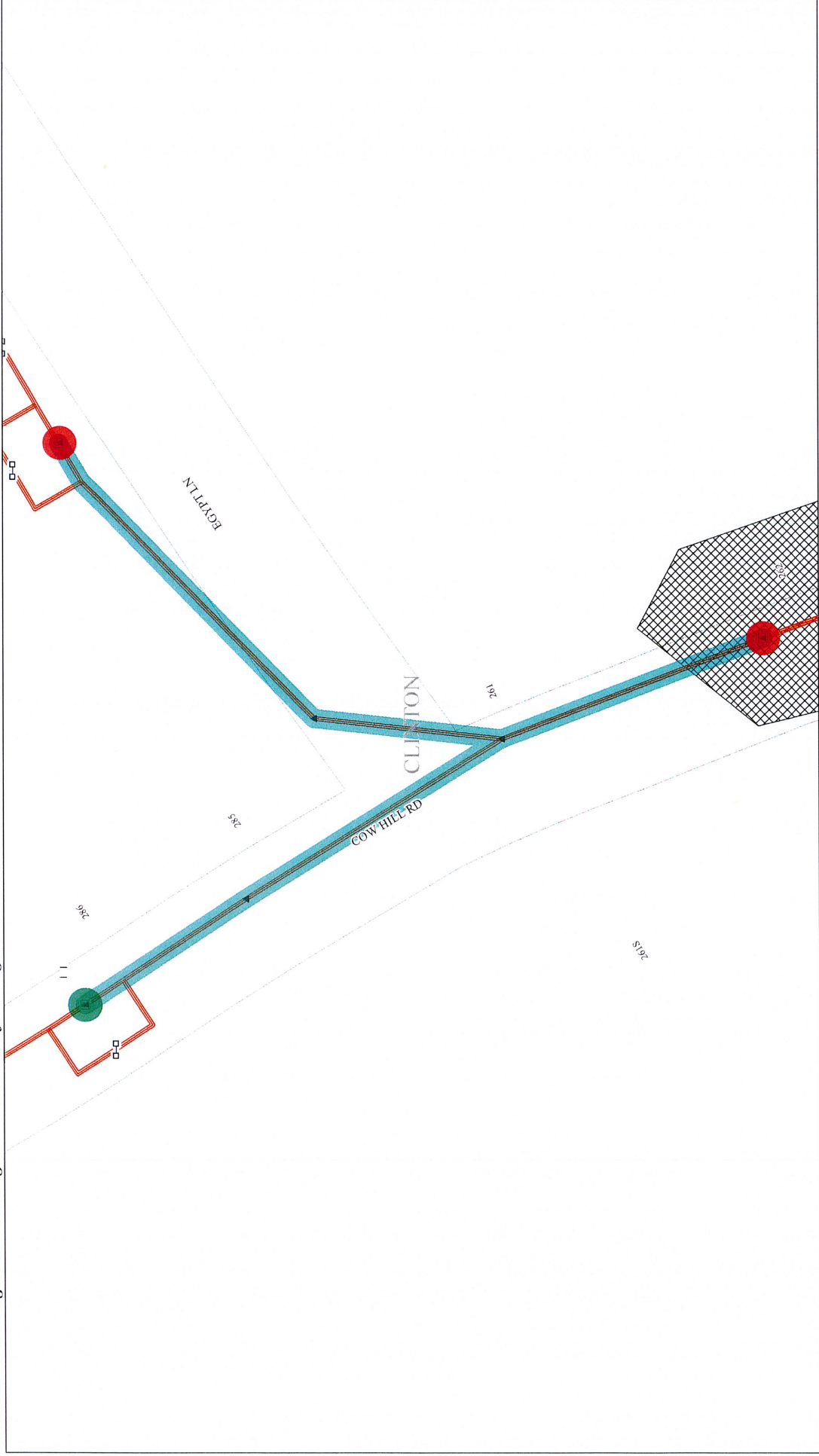

EVERSOURCE

PROPRIETARY INFORMATION: The material contained on the Overhead Distribution Circuit Map shall be considered proprietary to Eversource Energy, and Users (which shall be defined as any person or entity who has received the map through sale, purchase, exchange, gift, or otherwise) shall keep it in confidence and shall not furnish or disclose it to any third party without the prior written permission of Eversource Energy.

1 inch = 51 feet

- 1 | Open Point
- 1 | Sewerage Bank
- 1 | Tiepoint
- 1 | Primary Meter
- 1 | Switch Bank
- 1 | Cutout
- 1 | Pole
- 1 | Reelbox
- 1 | Street
- 1 | Railroad
- 1 | Substation
- 1 | Town Boundaries

Start Device: SCADA	VS 286-30R7-4000
Start Pole: 286	
Stop Pole(s): 258 / 262	
Scheduled Miles: 0.14	
2023 Circuit: N	

Poor Performing Device
Circuit: 30R7
Substation: GREEN HILL
Town: Clinton
AWC: MS

Plotted
1/10/2023

