

SOIL TESTING RESULTS:
Soil testing performed by the office of
Harkin Engineering, LLC (Michael P. Harkin, P.E.)

DEEP TEST PIT DATA

TEST PIT: #H8 (5/7/21)
0" - 6" Topsoil
6" - 60" Misc. fill material
60" - 144" (12') Original ground, silt w/
fine sand
Groundwater @ 60" (Static)
No Ledge
No Mottles

TEST PIT: #H9 (5/7/21)
0" - 6" Topsoil
6" - 48" Misc. fill material
48" - 144" (12') Original ground, silt w/
fine sand
Groundwater @ 48" (Static)
No Ledge
No Mottles

TEST PIT: #H10 (5/7/21)
0" - 6" Topsoil
6" - 60" Misc. fill material
60" - 144" (12') Original ground, silt w/
fine sand
Groundwater @ 60" (Static)
No Ledge
No Mottles

LEGEND			
SYMBOL	DESCRIPTION	SYMBOL	DESCRIPTION
●	PROPERTY CORNER	—	TREELINE
○	IP / REBAR	—	FENCE LINE
□	MON / MERESTONE	—	OVERHEAD WIRES
⊕	BENCH MARK	—	ROAD PAINTMARKS
○	UTILITY POLE	—	PROPERTY LINE
○	UTILITY POLE W/ LIGHT	—	PROPERTY LINE OTHER
—	GUY WIRE	—	INDEX CONTOUR
⊕	GAS VALVE	—	INTERMEDIATE CONTOUR
⊕	WATER VALVE	X.X'	SPOT ELEVATION
⊕	FIRE HYDRANT	■	PLANTED AREA
□	CATCH BASIN	■	GRAVEL AREA
□	MANHOLE	■	EXISTING BUILDING
—	SIGN	N/F	NOW OR FORMERLY
□	LIGHT POLE	ELEV / EL	ELEVATION
□	YARD LIGHT	INV	INVERT
○	WOOD POST	(TYP)	TYPICAL
⊕	DECIDUOUS TREE	(FC)	FACE OF CURB
⊕	CONIFEROUS TREE	(TC)	TOP OF CURB
○	SHRUB	R.C.P.	REINFORCED CONCRETE PIPE
⊕	STUMP	E.O.P.	EDGE OF PAVEMENT
⊕	HEDGE	B.C.L.C.	BIT. CONCRETE LIP CURB
⊕	STONEWALL	G.C.	GRANITE CURB

Subject Parcel Information

OWNER: TOWN OF CLINTON
PARCEL ADDRESS: OLD NOD ROAD, CLINTON, CONNECTICUT 06413
MAILING ADDRESS: 54 EAST MAIN STREET, CLINTON, CONNECTICUT 06413
PARCEL ID: MAP 19 BLOCK 6 LOT 1H
DEED: VOLUME 118 PAGE 240
FLOOD ZONE: ZONES X & AE PER FIRM MAP COMMUNITY PANEL #09007C0316J
DATED FEBRUARY 6, 2013

AREA OF TOPOGRAPHIC SURVEY IS IN THE FEMA FLOOD ZONE X & AE

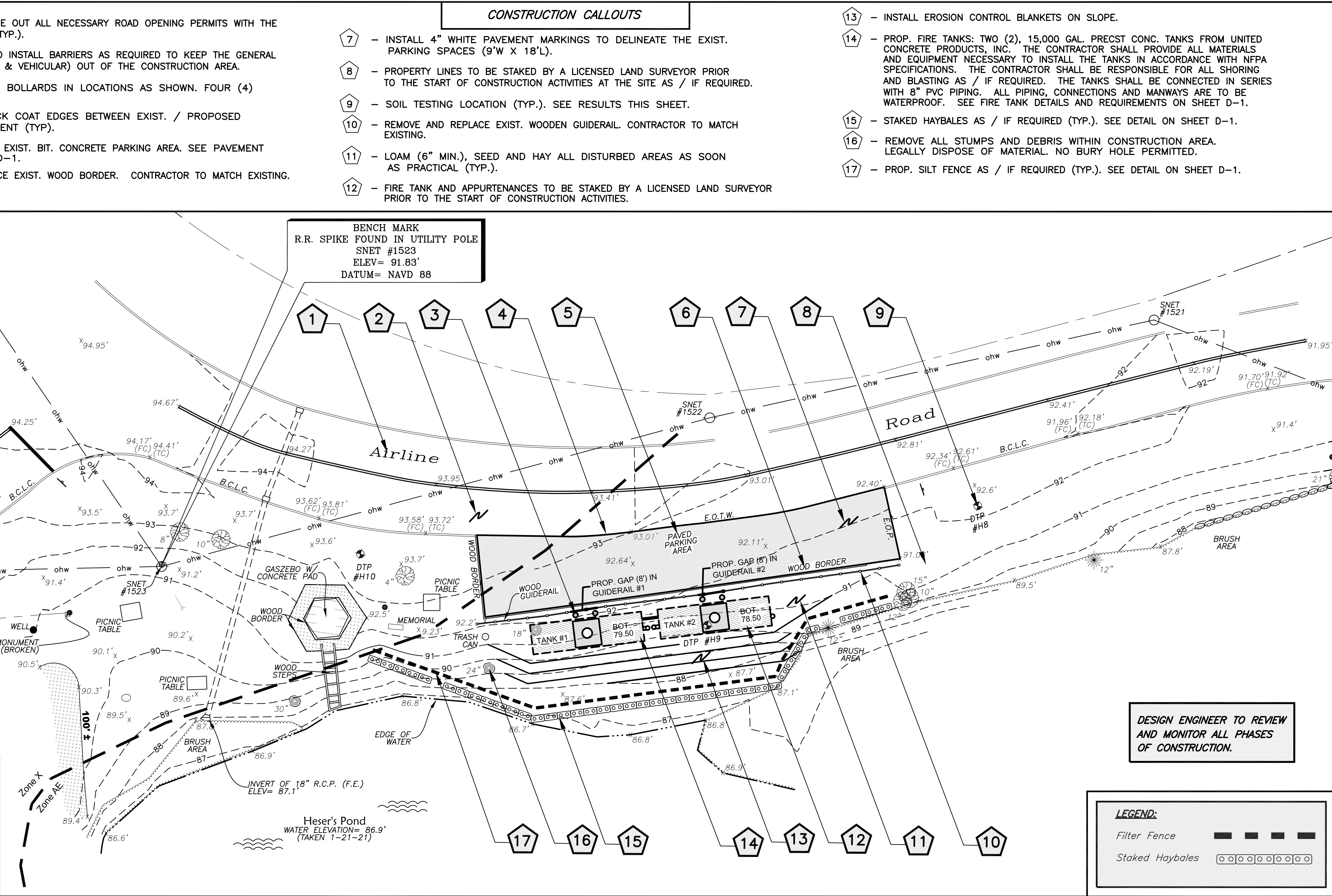

STAKEOUT / MARKING NOTE

The location of all improvements shown hereon shall be staked / marked out by the Licensed Land Surveyor (under the direction of the Design Engineer). Fire tank components shall be staked prior to the start of any of the construction activities. Coordination of the staking shall be done by the Design Engineer. No fees for the staking or engineering inspection shall be borne by the Contractor.

DEMOLITION NOTES

1. Contractor is to notify "Call Before You Dig" prior to any on-site construction activities.

2. The Contractor is responsible for legally disposing of all construction debris associated with the razing of on-site structures, trees, brush and shrubs.

PROJECT REQUIREMENTS

A mandatory pre-construction meeting with the Contractor, Town and Design Engineer is required prior to the commencement of any on-site construction activities.

EROSION CONTROL NOTE

All erosion control measures shown hereon shall be installed as directed / required by Design Engineer. More erosion control measures may be required depending on site conditions during construction. All erosion control measures shown on this plan are to be installed only as warranted.

NFPA CODES & STANDARDS NOTE

The Site Contractor shall review all National Fire Protection Association (NFPA) Codes & Standards as it relates to this project prior to the start of construction activities at the project site. The Site Contractor is to install all water tanks, tank appurtenances and buoyancy blocking in accordance with the most recent NFPA requirements (NFPA Section 22). The Design Engineer in conjunction with the Clinton Volunteer Fire Dept. will be tasked to verify compliance with the NFPA standards / requirements.

CALL BEFORE YOU DIG NOTE

All utilities shown are approximate and based upon actual field locations where visible. Notify "Call Before You Dig" prior to any on-site activities (1-800-922-4455).

DESIGN ENGINEER TO REVIEW AND MONITOR ALL PHASES OF CONSTRUCTION.

LEGEND:	
Filter Fence	—
Staked Haybales	□□□□□□□□

CONTRACTOR REVIEW NOTE

The Site Contractor is to verify all applicable NFPA installation requirements, existing site conditions and Federal/State/Local Building Codes & Requirements. Any discrepancies (slopes, locations, setbacks, computations, etc.) shall be brought to the design engineers attention immediately. Once the Contractors bid is accepted, the Contractor is liable for any required changes to the design plans or installation requirements if a discrepancy is discovered. The Contractor is solely responsible for their means and methods of install and full project implementation.

UTILITY NOTE

Remove & replace any utilities as necessary in-order to perform the required work.

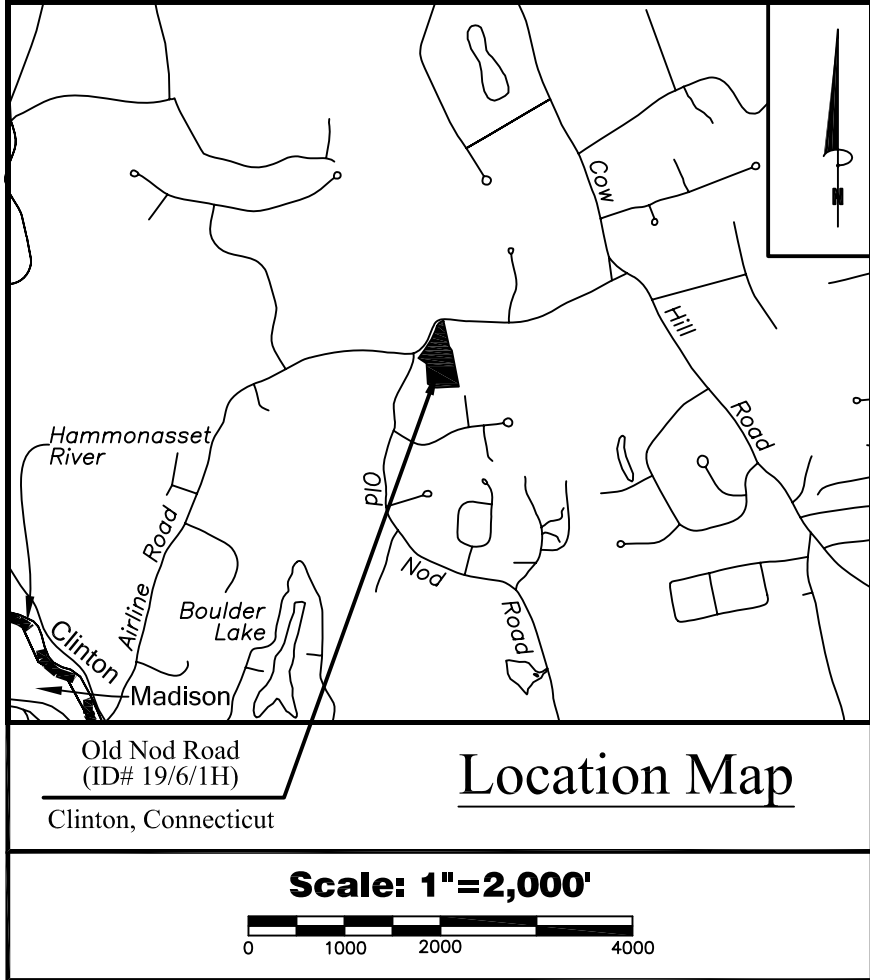

SURVEY NOTES:

1) THIS SURVEY PLAN HAS BEEN PREPARED PURSUANT TO THE REGULATIONS OF CONNECTICUT STATE AGENCIES SECTION 20-300B-1 THROUGH 20-300B-20 AND THE "STANDARDS FOR SURVEYS AND MAPS" IN THE STATE OF CONNECTICUT AS ADOPTED BY THE CONNECTICUT ASSOCIATION OF THE LAND SURVEYORS, INC. ON OCTOBER 28, 2018.

A. PROPERTY/BOUNDARY OR LIMITED PROPERTY/ BOUNDARY SURVEY AND IS SUBJECT TO SUCH FACTS AS SAID SURVEYS MAY DISCLOSE.

B. THIS MAP WAS PREPARED FROM RECORD RESEARCH, OTHER MAPS, LIMITED FIELD MEASUREMENTS AND OTHER SOURCES. IT IS NOT TO BE CONSTRUED AS

C. THIS SURVEY CONFORMS TO THE STANDARDS AND THE ACCURACY OF CLASS: A-2 HORIZONTAL & 1-2 TOPOGRAPHIC ACCURACY.

D. BEARINGS AS DEPICTED ARE BASED UPON THE CONNECTICUT GRID SYSTEM NORTH AMERICAN DATUM OF 1983

E. ELEVATIONS BASED UPON NORTH AMERICAN VERTICAL DATUM 1988

F. CONTOUR INTERVAL = 1'

G. THE INTENT OF THIS MAP IS TO DEPICT THE EXISTING CONDITIONS OF THE PROPERTY

2) BOUNDARY LINES OF ADJOINING PROPERTIES ARE SHOWN FOR GENERAL INFORMATION PURPOSES ONLY AND ARE NOT TO BE CONSTRUED AS BEING ACCURATELY LOCATED OR DEPICTED.

INSPECTIONS & TESTING NOTE

NFPA: 22 - STANDARD FOR WATER TANKS & PRIVATE FIRE PROTECTION (2018)

The Site Contractor is to have all their work inspected and tested in accordance with NFPA: 22 requirements.

ROAD CLOSURE & TRAFFIC CONTROL NOTE

If the fire tank installation requires the need for road closure, then the Contractor shall put together a written plan with times and dates. The plan shall include the description of all barriers, signs, traffic control devices and the use of local police as / if required. The proposed plan is to be reviewed and approved by the Design Engineer, Fire Dept., Police Dept. and Public Works officials. All costs associated with the road closure shall be paid for by the Contractor.

APPROVAL SET NOT FOR CONSTRUCTION

SCHEMATIC SITE DEVELOPMENT PLAN

Prepared for

TOWN OF CLINTON

"FIRE DEPT. WATER SUPPLY IMPROVEMENT PROJECT"

HESERS POND - ID# 19/6/1H

CLINTON, CONNECTICUT

DRAWING SCALE: 1"=20'

HARKIN ENGINEERING, LLC

CIVIL ENGINEERING CONSULTING

78 Wolf Hollow Lane - Killingworth, CT 06419 - Tel. (860) 663-4248

JOB NO. 21-21a DRAWN BY: M.P.H. DATE: 1/26/22 SHEET NO. SP-1

OWNER / APPLICANT:

Town of Clinton
Mr. Karl F. Kilduff (Town Manager)
#54 East Main Street
Clinton, CT 06413
(860) 669-9333



GESICK & ASSOCIATES, P.C.
SURVEYORS • MAPPERS • PLANNERS
19 CEDAR ISLAND AVE.
CLINTON, CONN 06413
(860) 669-7799

NO.	DATE	REVISIONS
1	5/25/22	Misc. Notes
2	6/6/22	Town Manager Comments
3	7/20/22	Tank Manufacturer
Michael P. Harkin P.E. #22625		

