



THE VILLAGE AT MILL POND
11 KILLINGWORTH TURNPIKE
CLINTON, CONNECTICUT 06413

REVISIONS	Date	Description
No. 1.	1/22/16	GENERAL REVISION
No. 2.	2/24/16	REVISED PER REVIEW COMMENTS
No. 3.	2/25/16	REVISED PER TOWN COMMENTS

Designed	E.C.P.
Drawn	E.C.P.
Checked	---
Approved	M.M.C.
Scale	1"=40'
Project No.	14C4892
Date	1/4/16

CAD File: SP14C489201

Title: **SITE PLAN**

Sheet No.

SP-3

Xref (G): X14C489201; XG14C489202; 24-36

LEGEND

- CONCRETE PAVEMENT
- PAVERS
- SAWCUT LINE. MATCH EXISTING GRADE.
- RETAINING WALL
- 6" CURB
- WETLANDS AREA
- 100' WETLANDS UPLAND REVIEW
- LIMIT OF DISTURBANCE
- LOD
- PROPOSED 9'x18' PARKING SPACE INDICATOR
- PAINTED DIRECTIONAL ARROW
- PAINTED STOP BAR
- PROPERTY LINE
- BUILDING SETBACK
- RESIDENTIAL SETBACK
- PARKING SETBACK
- ADVANCED WASTEWATER TREATMENT
- AQUIFER PROTECTION ZONE LINE

LIMIT OF DISTURBANCE EQUALS LIMIT OF GRADING REFER TO SHEET GD-0 THRU GD-3

- SEE SHEETS GD-0 THRU GD-3 FOR GRADING AND DRAINAGE
- SEE SHEETS GD-0 THRU GD-3 FOR EXISTING/PROPOSED CONTOUR INFORMATION
- SEE SHEETS EC-1 THRU EC-8 FOR EROSION AND SEDIMENTATION CONTROL
- SEE SHEETS EC-1 THRU EC-6 FOR SOIL TYPES
- SEE SHEETS SU-1 THRU SU-3 FOR SITE UTILITIES
- SEE SHEETS LL-0 THRU LL-4 FOR LANDSCAPING
- SEE SHEETS WLS-109658 FOR LIGHTING/PHOTOMETRICS
- SEE SHEETS BS-1 THRU BS-3 FOR ALL EXISTING CONDITIONS INFORMATION

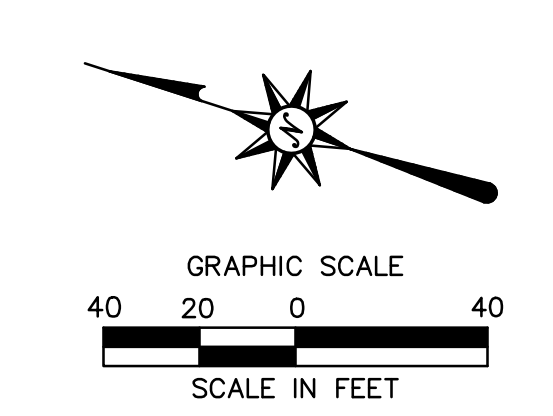
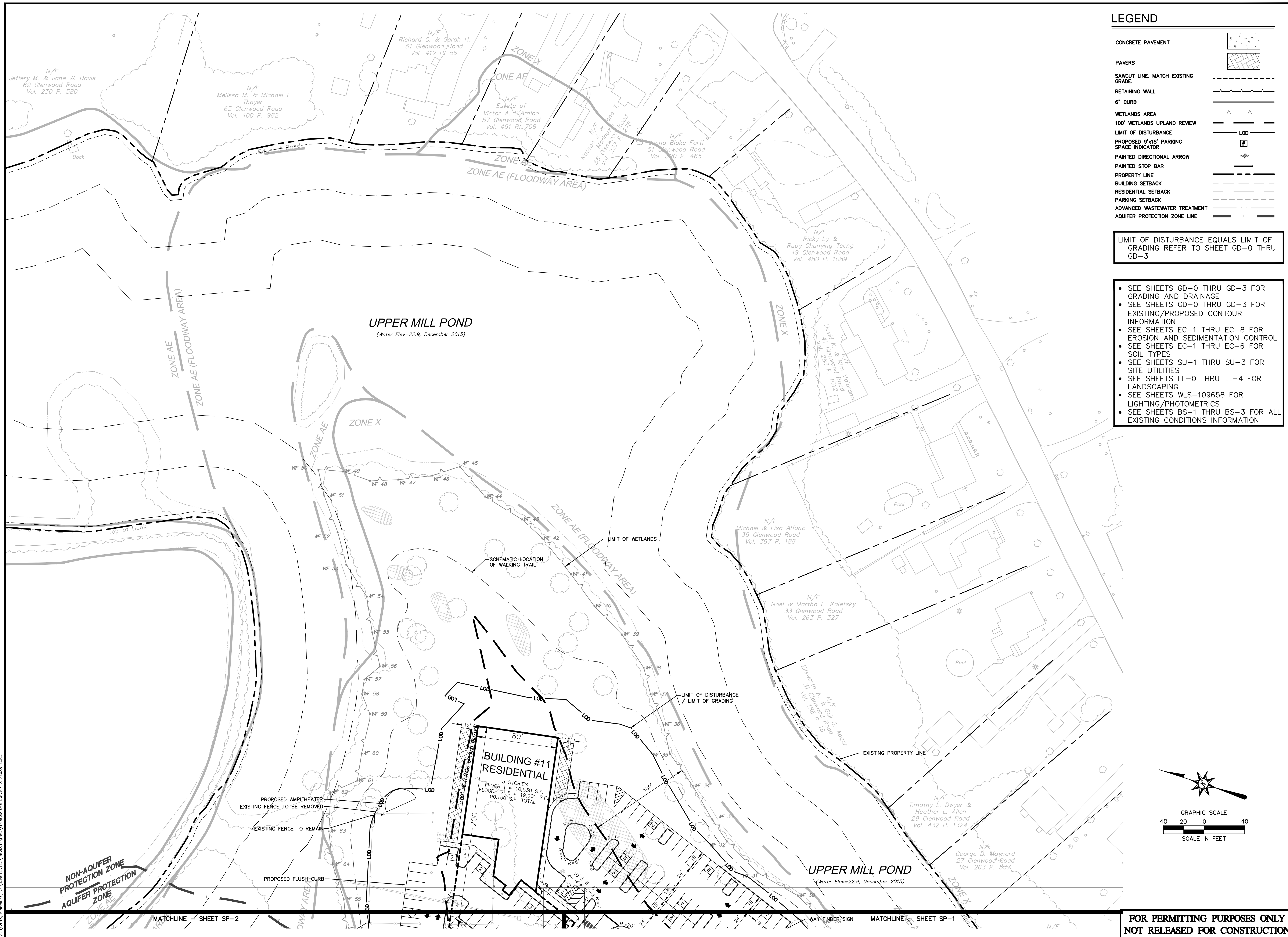

2/29/2016, 10:05 AM, E:\PROJECTS\14C4892\DWG\SP14C489201.DWG, P. 3, 24x36, 40SC

**FOR PERMITTING PURPOSES ONLY
NOT RELEASED FOR CONSTRUCTION**