



THE VILLAGE AT MILL POND
11 KILLINGWORTH TURNPIKE
CLINTON, CONNECTICUT 06413

REVISIONS
Desc. GENERAL REVISION

No. 1 Date 1/22/16
Designed WEV
Drawn WEV
Checked ---
Approved ---
Scale 1"=40'
Project No. 14C4892
Date 1/4/16
CAD File: WB14C489201
Title WETLAND BUFFER ENHANCEMENT PLAN
Sheet No.

PLANTING KEY

- PROPOSED DECIDUOUS TREE
- PROPOSED EVERGREEN TREE
- PROPOSED SHRUB

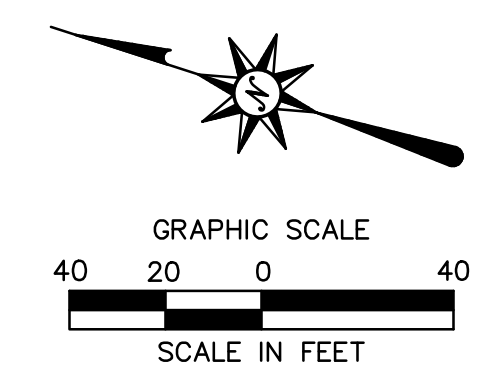
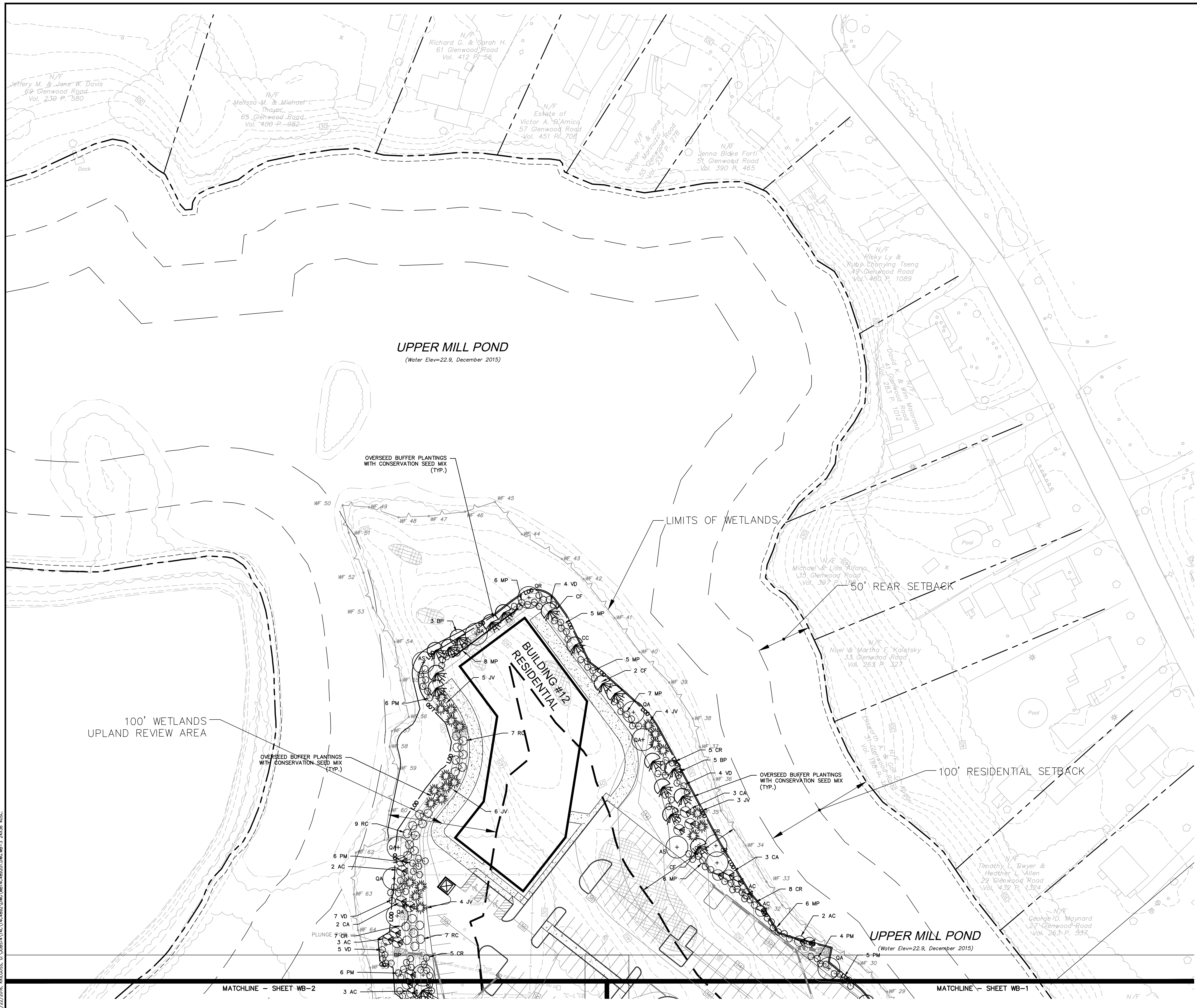

**FOR PERMITTING PURPOSES ONLY
NOT RELEASED FOR CONSTRUCTION**

**REFER TO SHEET WB-0 FOR PLANT
SCHEDULE AND SHEET WB-4 FOR
WETLAND BUFFER
ENHANCEMENT NOTES**

1/22/2016, KKL/GSS, G:\00614\14C4892\DWG\WB14C489201.DWG, WB-3, 24x36, 40SC.